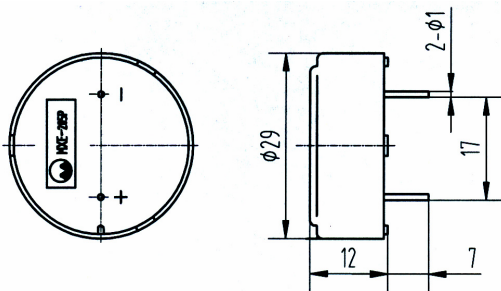
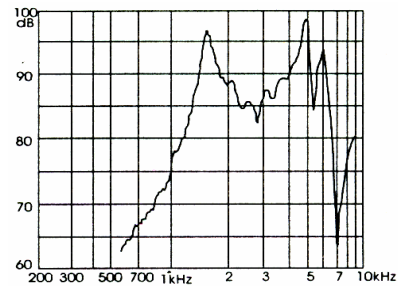

*Speaker***MXE-205P****DIMENSIONS:(Unit: mm)****FEATURES:**

- Printed Circuit Mounting
- Wave Solder able
- 8 ohm Stand and Impedance

APPLICATIONS:

- Automatic Control Equipment
- Communication Equipment
- Electronic Instruments

CHARACTERISTICS:**ELECTRICAL SPECIFICATIONS:**

Min. Sound Pressure Level at

1500±200Hz /1.1V_{RMS} Sine Wave/ 10cm.....84dB

Rated Power.....0.15W

Max. Power.....0.3W

Operating Frequency.....700~5000Hz

Resonant Frequency.....1500±200Hz

Rated Impedance.....8Ω

Operating Temperature.....-20~+70°C

Case Material/Color.....PC/Black

Weight.....9g

PACKING INFORMATION:

Packing: 1000 pcs per export carton

Carton Size: 47×30.5×23cm

G. Weight: 10.5kgs N. Weight: 9 kgs

Address: No. 12. Lane 722. Sangtian Road Jiangdong, Ningbo, 315040 P. R. China

Sales Tel: +86-574-87809820(International)/87805605(Domestic)

Fax: +86-574-87803761



REVISION HISTORY				
REV	DESCRIPTION	ISSUED BY/DATE	CHECKED	APPROVED
3	Add:“RoHS Compliant” Tab	ZHOUHONGGANG MAR. 24, 2010	ZHANGCHUNLEI	WANGJIANCHENG