

DIP Power Inductor – DM Series

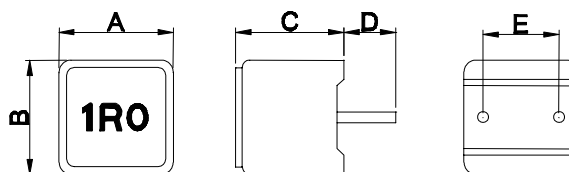

DM0708



DM1310

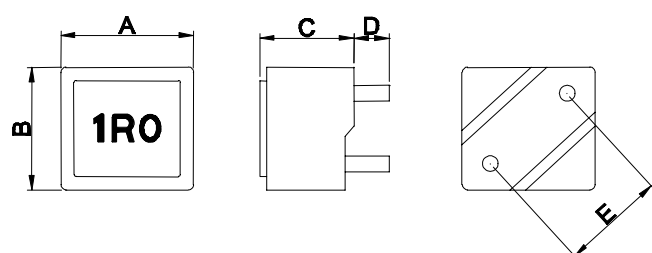

DM0808 / 1210

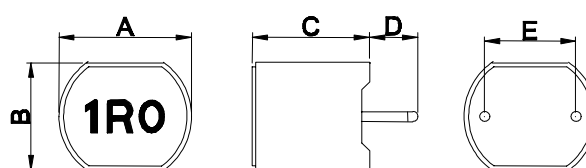

■ Dimensions

Unit: mm

Type	A	B	C Max.	D	E
DM0708	7.5±0.5	7.5±0.5	8.5	3.4±0.5	5.0±0.4
DM0808	8.7±0.5	7.2±0.5	8.5	3.4±0.5	6.0±0.5
DM1210	12.3±0.5	10.2±0.5	10.0	3.4±0.5	8.0±0.5
DM1310	13.0±0.5	12.0±0.5	10.0	3.4±0.5	10.0±0.5

■ Features

- Ultra low cost
- Shielded construction
- High current rating up DC 40A
- High frequency range up to 500KHz
- Very low DC resistance
- Low noise

■ Applications

- Motherboards For Laptop And Desktop Computers
- DC/DC Converter

■ Characteristics

- Saturation Rated Current (I_{DC}/I_{sat}) : The DC current when the inductance becomes 20% Typ its initial value. ($T_a=25^\circ\text{C}$)
- Temperature Rise Current (I_{rms}) : The actual current when temperature of coil becomes $\Delta 40^\circ\text{C}$ ($T_a=25^\circ\text{C}$)
- Operating Temperature Range : $-25^\circ\text{C} \sim 125^\circ\text{C}$

■ Inductance and rated current ranges

- DM0708 0.56~4.7 μH 32~12A
- DM0808 0.56~4.7 μH 32~12A
- DM1210 0.22~4.7 μH 56~15A
- DM1310 0.33~2.2 μH 55~25A

– Electrical specifications at 25°C

Product Identification

DM	1210	M	B	R50
Product Type	Dimensions (AxBxC)	Inductor Tolerance	Packaging Style	Inductance
	0708: 7.5x7.5x8.5 0808: 8.7x7.2x8.5 1210: 12.3x10.2x10 1310: 13.0x12.0x10	M: $\pm 20\%$	B: Bulk	R25: 0.25 μ H R50: 0.5 μ H 1R0: 1.0 μ H 100: 10 μ H

Electrical Characteristics

DM0708 Type

Codes	L (μ H)	Tolerance	Test Condition	DCR (m Ω) Max	IDC (A) Max
R56	0.56	M	100KHz, 0.1V	2.50	32
1R0	1.0	M	100KHz, 0.1V	5.60	21
1R5	1.5	M	100KHz, 0.1V	7.50	18
2R2	2.2	M	100KHz, 0.1V	10.0	16
2R8	2.8	M	100KHz, 0.1V	11.8	15
3R3	3.3	M	100KHz, 0.1V	13.6	14
4R7	4.7	M	100KHz, 0.1V	17.0	12

DM0808 Type

Codes	L (μ H)	Tolerance	Test Condition	DCR (m Ω) Max	IDC (A) Max
R56	0.56	M	100KHz, 0.1V	2.50	32
1R0	1.0	M	100KHz, 0.1V	5.60	21
1R5	1.5	M	100KHz, 0.1V	7.50	18
2R2	2.2	M	100KHz, 0.1V	10.0	16
2R8	2.8	M	100KHz, 0.1V	11.8	15
3R3	3.3	M	100KHz, 0.1V	13.6	14
4R7	4.7	M	100KHz, 0.1V	17.0	12

■ Electrical Characteristics

DM1210 Type

Codes	L (μ H)	Tolerance	Test Condition	DCR ($m\Omega$) Max	IDC (A) Max
R22	0.22	M	100KHz, 0.1V	0.60	56
R33	0.33	M	100KHz, 0.1V	0.80	48
R36	0.36	M	100KHz, 0.1V	0.80	45
R39	0.39	M	100KHz, 0.1V	0.80	45
R47	0.47	M	100KHz, 0.1V	1.00	40
R56	0.56	M	100KHz, 0.1V	1.00	40
R60	0.60	M	100KHz, 0.1V	1.00	40
R68	0.68	M	100KHz, 0.1V	1.00	40
R80	0.80	M	100KHz, 0.1V	1.25	36
1R0	1.0	M	100KHz, 0.1V	2.00	32
1R5	1.5	M	100KHz, 0.1V	3.50	30
2R2	2.2	M	100KHz, 0.1V	5.00	24
2R8	2.8	M	100KHz, 0.1V	6.40	20
3R3	3.3	M	100KHz, 0.1V	7.70	16
4R7	4.7	M	100KHz, 0.1V	10.0	15

DM1310 Type

Codes	L (μ H)	Tolerance	Test Condition	DCR ($m\Omega$) Max	IDC (A) Max
R33	0.33	M	100KHz, 0.1V	0.65	55
R39	0.39	M	100KHz, 0.1V	0.65	55
R47	0.47	M	100KHz, 0.1V	0.80	54
R56	0.56	M	100KHz, 0.1V	0.80	52
R60	0.60	M	100KHz, 0.1V	0.80	52
R68	0.68	M	100KHz, 0.1V	0.80	50
R80	0.80	M	100KHz, 0.1V	0.85	48
1R0	1.00	M	100KHz, 0.1V	1.35	40
1R5	1.50	M	100KHz, 0.1V	1.70	38
2R2	2.20	M	100KHz, 0.1V	3.30	25